

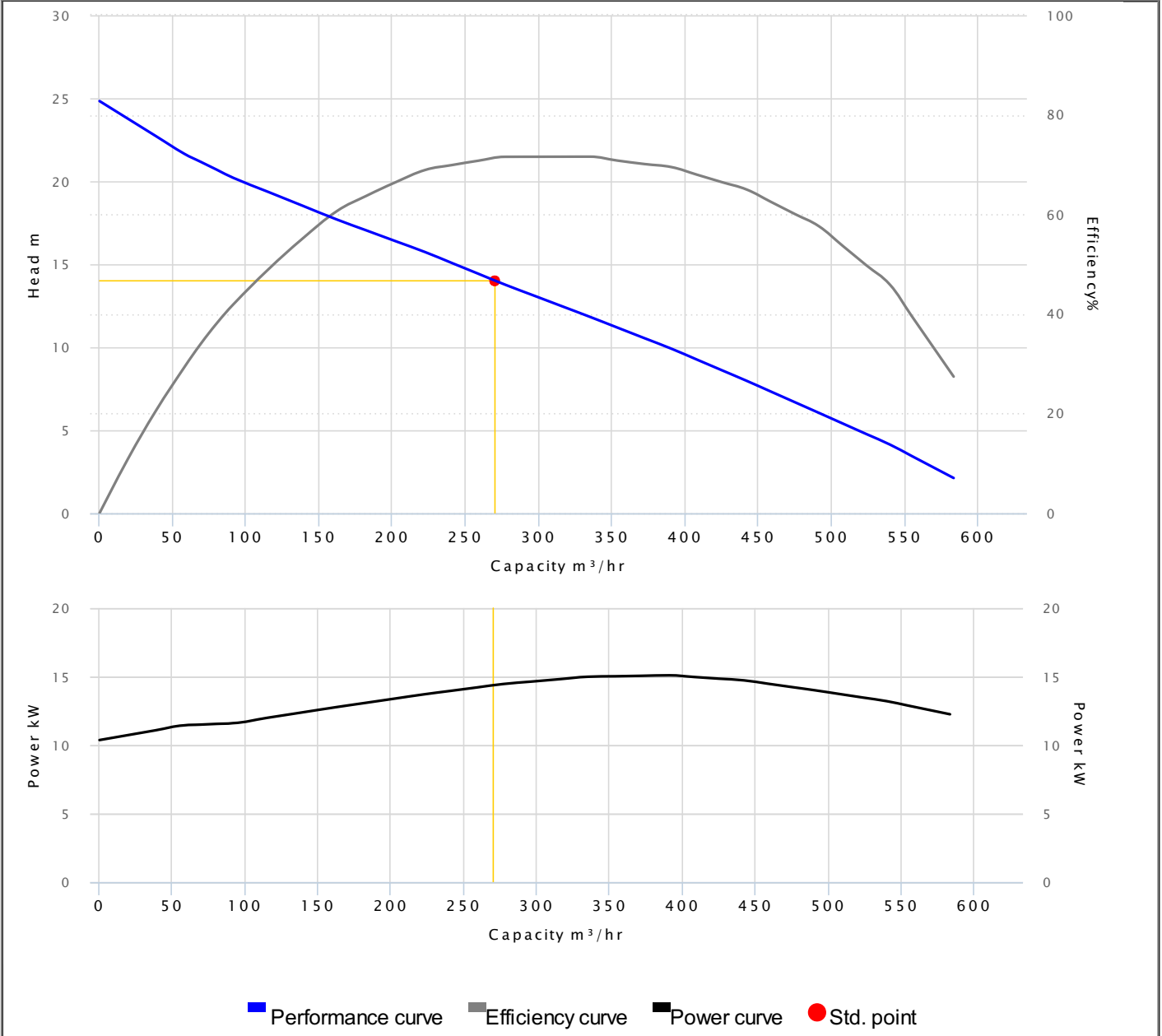

# HCP PUMP

## PUMP PERFORMANCE CURVES

<b>Model</b>	AF-820A		
<b>Frequency</b>	50 Hz		
<b>Discharge</b>	8" / 200 mm		
<b>Power</b>	20 HP / 15 kW		
<b>Std. Head</b>	14 m		
<b>Std. Capacity</b>	270 m <sup>3</sup> /hr		
<b>Phase/Volt</b>	3 Ø / 380 V		
<b>Rated Current</b>	31.00 A		
<b>rpm</b>	4 P / 1450 rpm		
<b>Start Method</b>	STAR-DELTA		
<b>Insulation Class</b>	H		
<b>Solid Passage</b>	75 mm	<b>Output</b>	14.37 kW



## DIMENSIONS

NO: S8AF04A5A30-00

MODEL: AF-815A / 820A

50Hz 3Ø

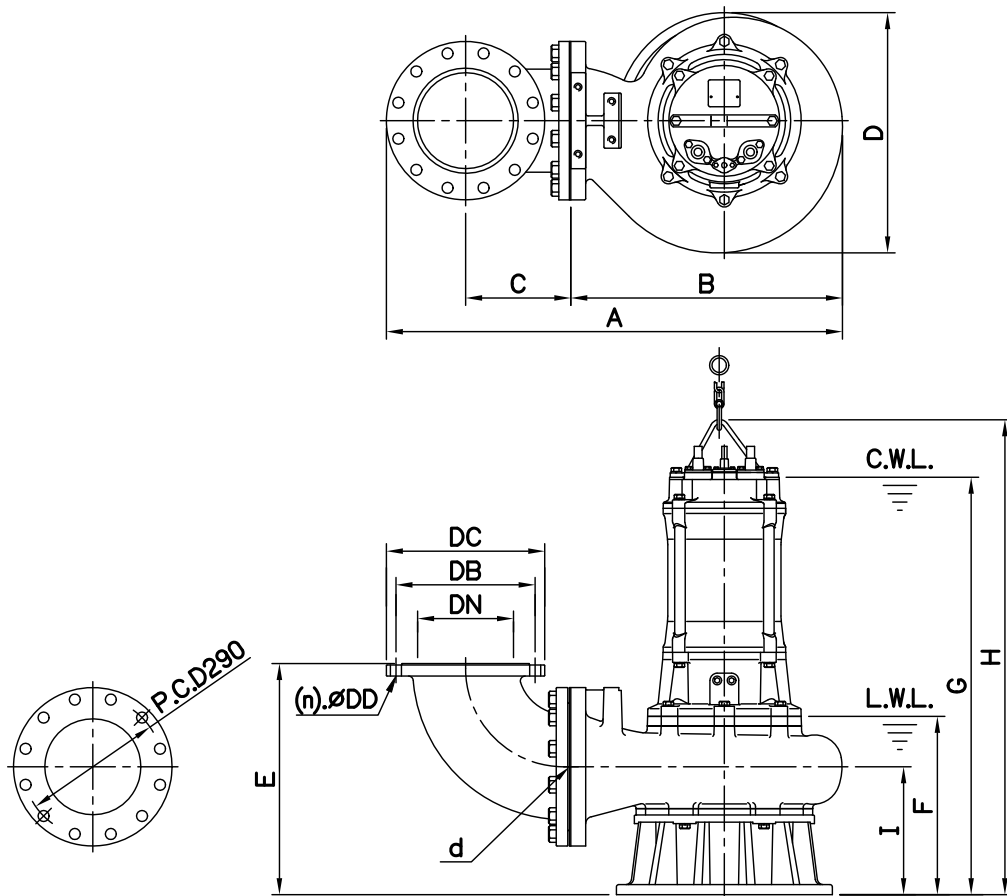

Dimensions—mm

Weight:kg

Model	d	A	B	C	D	E	F	G	H	I	WT1	Elbow (Flange)Set	DN	DB	DC	DD	(n)QTY	WT2
AF-815A	200	950	566	219	501	483	372	870	990	267	211	EB8-290	200	290	330	23	12	44
AF-820A	200	950	566	219	501	483	372	870	990	267	223	EB8-290	200	290	330	23	12	44

Dimensions—inch

Weight:lb

Model	d	A	B	C	D	E	F	G	H	I	WT1	Elbow (Flange)Set	DN	DB	DC	DD	(n)QTY	WT2
AF-815A	8	37 <sup>3</sup> / <sub>8</sub>	22 <sup>5</sup> / <sub>8</sub>	8 <sup>5</sup> / <sub>8</sub>	19 <sup>3</sup> / <sub>4</sub>	19	14 <sup>5</sup> / <sub>8</sub>	34 <sup>1</sup> / <sub>8</sub>	39	10 <sup>1</sup> / <sub>2</sub>	465	EB8-290	8	11 <sup>1</sup> / <sub>8</sub>	13	7/8	12	97
AF-820A	8	37 <sup>3</sup> / <sub>8</sub>	22 <sup>5</sup> / <sub>8</sub>	8 <sup>5</sup> / <sub>8</sub>	19 <sup>3</sup> / <sub>4</sub>	19	14 <sup>5</sup> / <sub>8</sub>	34 <sup>1</sup> / <sub>8</sub>	39	10 <sup>1</sup> / <sub>2</sub>	492	EB8-290	8	11 <sup>1</sup> / <sub>8</sub>	13	7/8	12	97

C.W.L.:Continuous Running Water Level  
L.W.L.:Lowest Running Water Level

WT1:Pump Weight(Without Cable)  
WT2:Elbow Set Weight

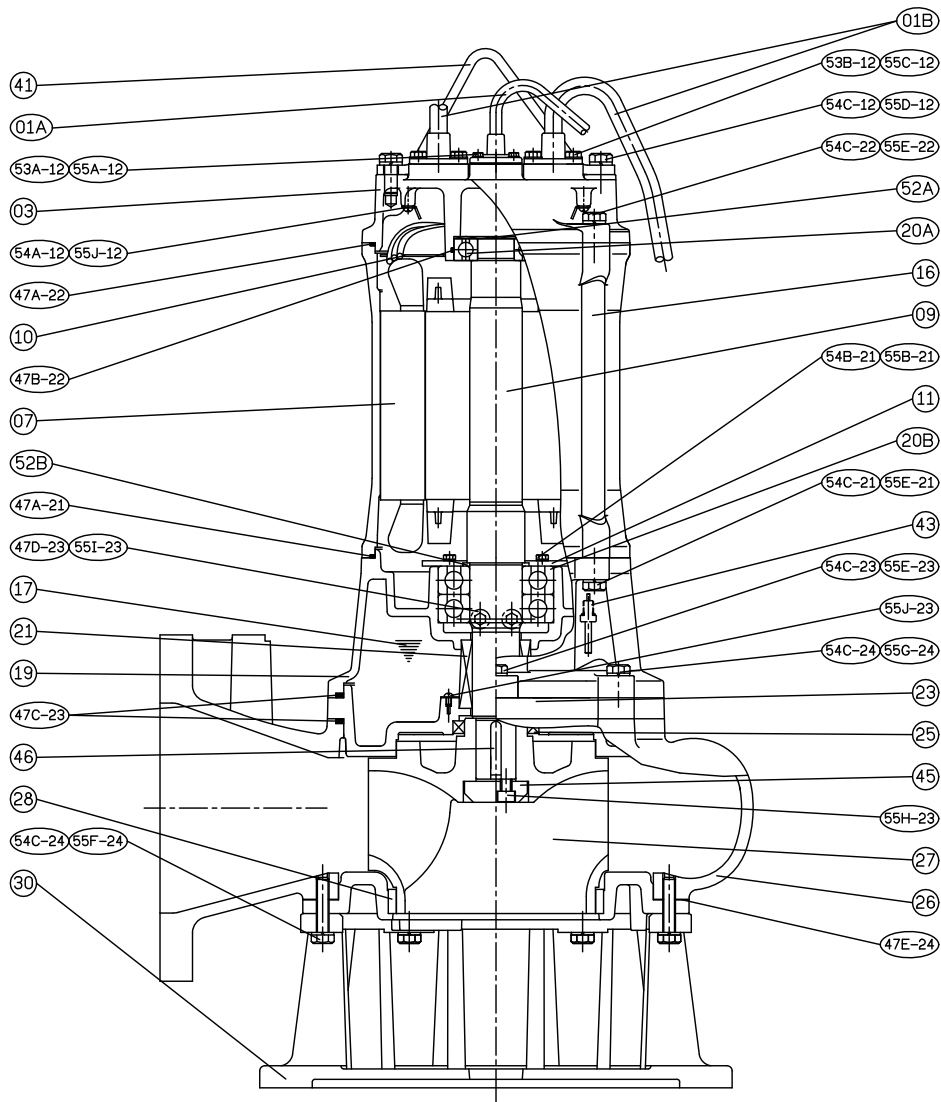

No.	Part name	Material	QTY	Remark
01	Cable		3	
03	Upper cover	FC200	1	
07	Stator		1	With MTS
09	Shaft end	SUS420J2	1	
10	Protective Plate		1	
11	Bearing fixer	SPCC	1	
16	Motor frame	FC200	1	
17	Lubricant			
19	Bearing bracket	FC200	1	
20A	Bearing		1	
20B	Bearing		2	
21	M.seal	CA / CE & SIC / SIC	1	
23	M. seal bracket	FC200	1	

No.	Part name	Material	QTY	Remark
25	Oil seal	NBR	1	
26	Casing	FC200	1	
27	Impeller	FC200	1	
28	Casing cover	FC200	1	
	+Wear ring	Chrome steel	1	
30	Footing	FC200	1	
41	Handle	SUS304	1	
43	Moisture sensor		1	
46	Impeller key	SUS304	1	
47	Packing			