

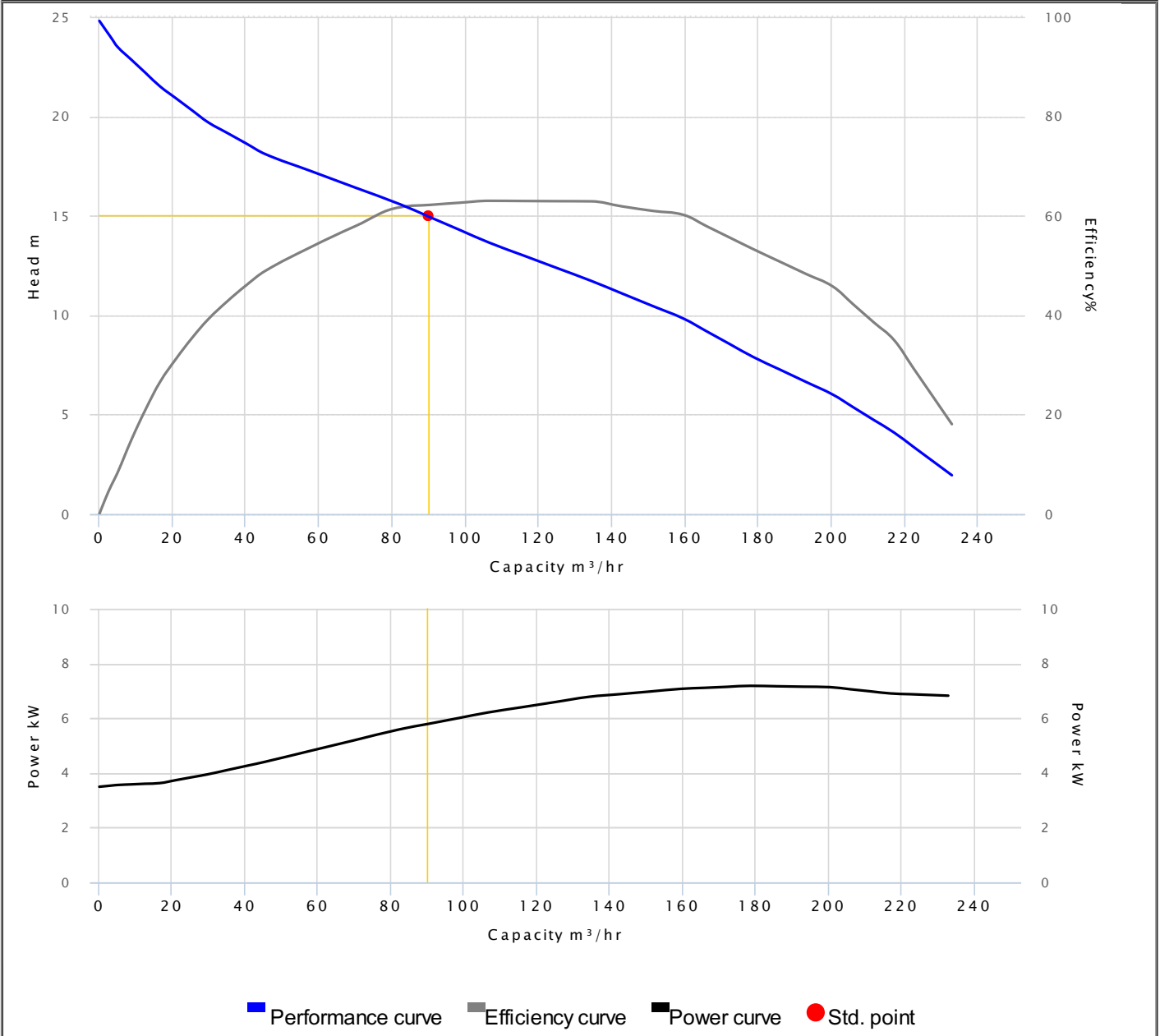

# HCP PUMP

## PUMP PERFORMANCE CURVES

<b>Model</b>	100(150)AFE47.5		
<b>Frequency</b>	50 Hz		
<b>Discharge</b>	6" / 150 mm		
<b>Power</b>	10 HP / 7.5 kW		
<b>Std. Head</b>	15 m		
<b>Std. Capacity</b>	90 m <sup>3</sup> /hr		
<b>Phase/Volt</b>	3 Ø / 380 V		
<b>Rated Current</b>	16.30 A		
<b>rpm</b>	4 P / 1450 rpm		
<b>Start Method</b>	DIRECT		
<b>Insulation Class</b>	H	<b>Efficiency</b>	62.2 %
<b>Solid Passage</b>	76 mm	<b>Output</b>	5.79 kW



## DIMENSIONS

NO: S4AFE475030-00

MODEL: 100(150)AFE45.5 / 47.5

50Hz 3Ø

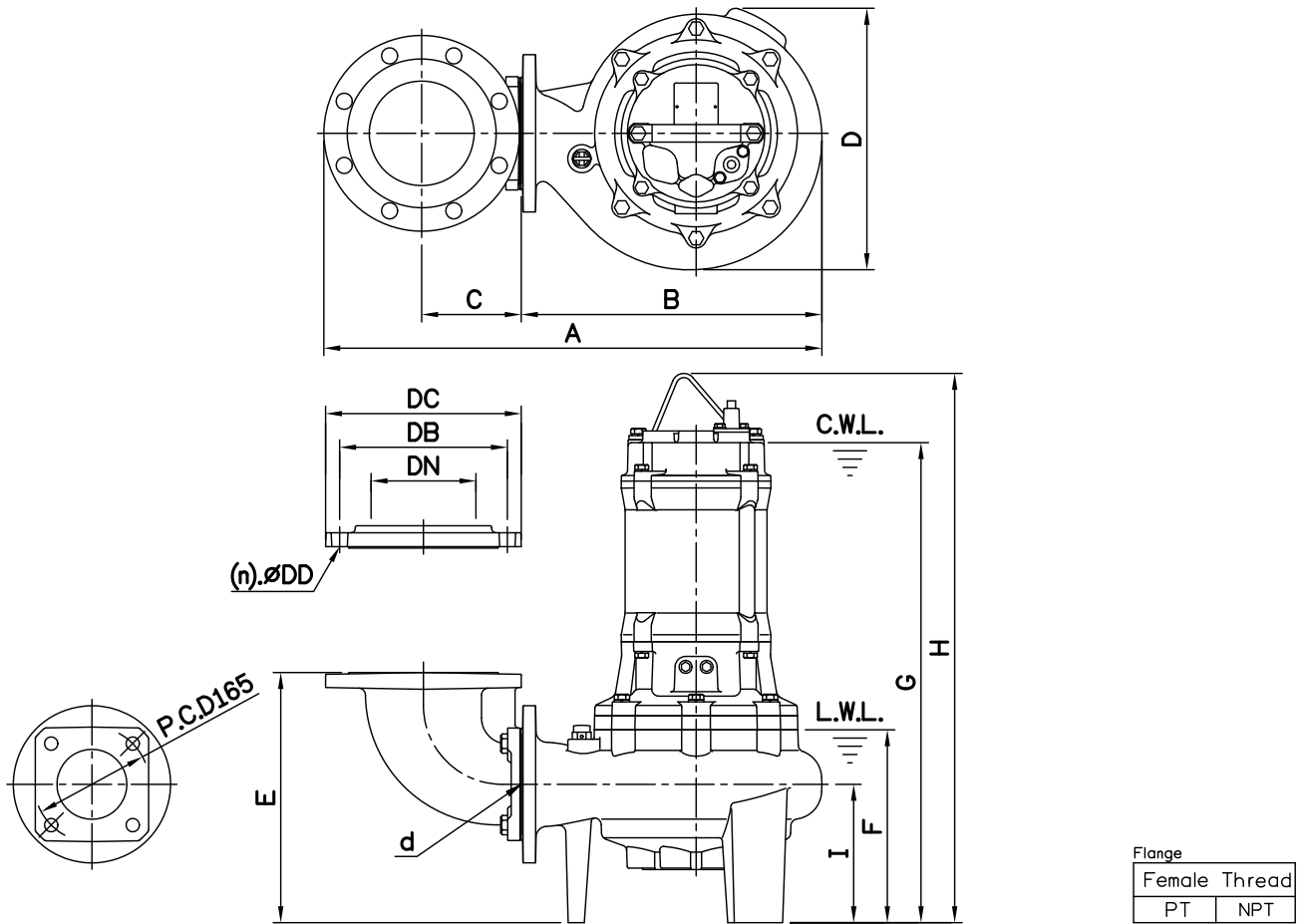

Dimensions—mm

Weight:kg

Model	d	A	B	C	D	E	F	G	H	I	WT1	Elbow (Flange)Set	DN	DB	DC	DD	(n)QTY	WT2
100(150)AFE45.5	100	653	430	113	374	328	276	687	786	198	110	EB4-175A	100	175	210	15	8	13
100(150)AFE45.5	100	713	430	143	374	358	276	687	786	198	110	EB6-240(165)	150	240	280	23	8	23
100(150)AFE47.5	100	653	430	113	374	328	276	727	826	198	120	EB4-175A	100	175	210	15	8	13
100(150)AFE47.5	100	713	430	143	374	358	276	727	826	198	120	EB6-240(165)	150	240	280	23	8	23

Dimensions—inch

Weight:lb

Model	d	A	B	C	D	E	F	G	H	I	WT1	Elbow (Flange)Set	DN	DB	DC	DD	(n)QTY	WT2
100(150)AFE45.5	4	25 <sup>7</sup> / <sub>8</sub>	16 <sup>5</sup> / <sub>8</sub>	4 <sup>1</sup> / <sub>8</sub>	14 <sup>3</sup> / <sub>4</sub>	12 <sup>5</sup> / <sub>8</sub>	10 <sup>7</sup> / <sub>8</sub>	27 <sup>1</sup> / <sub>4</sub>	30 <sup>3</sup> / <sub>8</sub>	7 <sup>7</sup> / <sub>8</sub>	243	EB4-175A	4	6 <sup>3</sup> / <sub>4</sub>	8 <sup>1</sup> / <sub>4</sub>	3	8	29
100(150)AFE45.5	4	28 <sup>1</sup> / <sub>8</sub>	16 <sup>5</sup> / <sub>8</sub>	5 <sup>5</sup> / <sub>8</sub>	14 <sup>3</sup> / <sub>4</sub>	14 <sup>1</sup> / <sub>2</sub>	10 <sup>7</sup> / <sub>8</sub>	27 <sup>1</sup> / <sub>4</sub>	30 <sup>3</sup> / <sub>8</sub>	7 <sup>7</sup> / <sub>8</sub>	243	EB6-240(165)	6	9 <sup>3</sup> / <sub>4</sub>	11	7	8	51
100(150)AFE47.5	4	25 <sup>7</sup> / <sub>8</sub>	16 <sup>5</sup> / <sub>8</sub>	4 <sup>1</sup> / <sub>8</sub>	14 <sup>3</sup> / <sub>4</sub>	12 <sup>5</sup> / <sub>8</sub>	10 <sup>7</sup> / <sub>8</sub>	28 <sup>3</sup> / <sub>4</sub>	32 <sup>1</sup> / <sub>2</sub>	7 <sup>7</sup> / <sub>8</sub>	265	EB4-175A	4	6 <sup>3</sup> / <sub>4</sub>	8 <sup>1</sup> / <sub>4</sub>	3	8	29
100(150)AFE47.5	4	28 <sup>1</sup> / <sub>8</sub>	16 <sup>5</sup> / <sub>8</sub>	5 <sup>5</sup> / <sub>8</sub>	14 <sup>3</sup> / <sub>4</sub>	14 <sup>1</sup> / <sub>2</sub>	10 <sup>7</sup> / <sub>8</sub>	28 <sup>3</sup> / <sub>4</sub>	32 <sup>1</sup> / <sub>2</sub>	7 <sup>7</sup> / <sub>8</sub>	265	EB6-240(165)	6	9 <sup>3</sup> / <sub>4</sub>	11	7	8	51

C.W.L.:Continuous Running Water Level  
L.W.L.:Lowest Running Water Level

WT1:Pump Weight(Without Cable)  
WT2:Elbow Set Weight

## DIMENSIONS

NO: T6AFE475030-00

MODEL: 100(150)AFE45.5 / 47.5

50Hz 3Ø

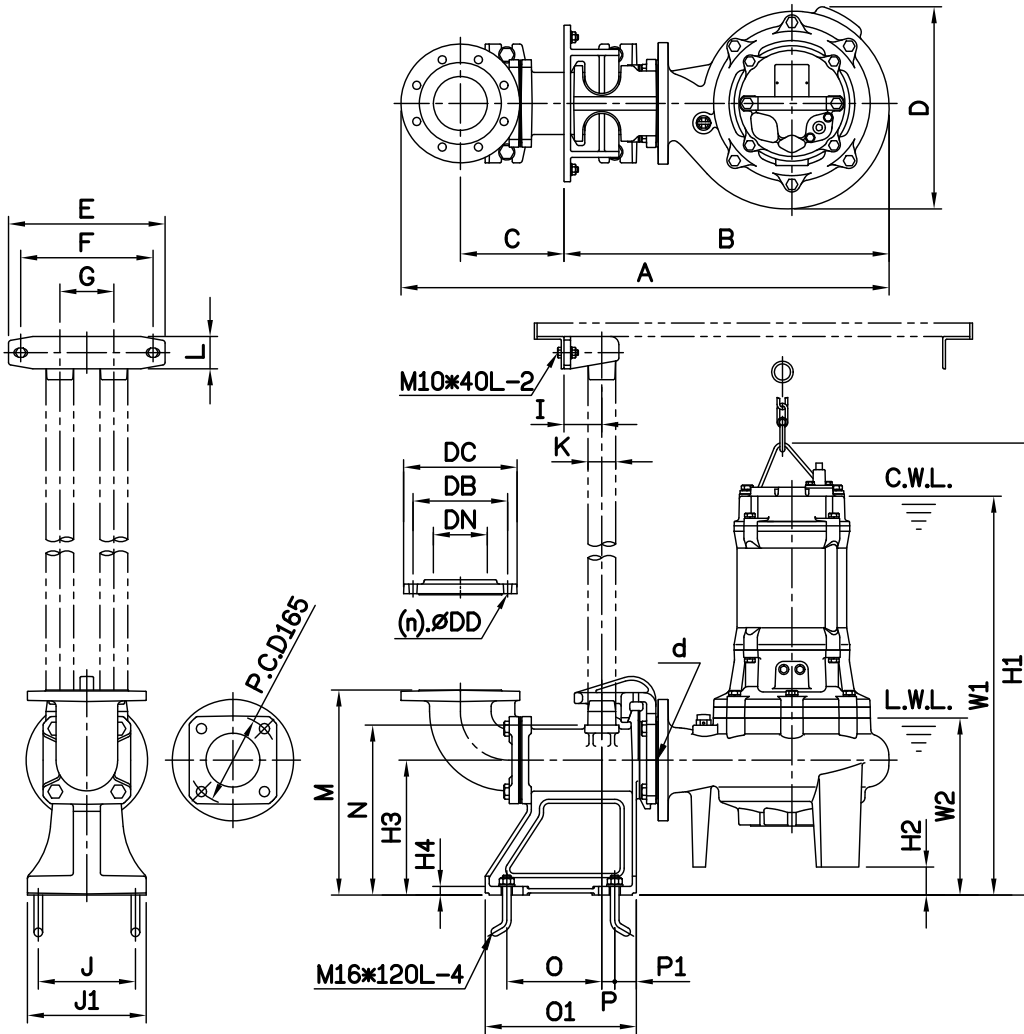

Flange	
Female Thread	
PT	NPT

Dimensions-mm

Elbow (Flange)Set	DN	DB	DC	DD	(n)QTY
EF4-175	100	175	210	15	8
EF6-240	150	240	280	23	8

Dimensions-inch

Elbow (Flange)Set	DN	DB	DC	DD	(n)QTY
EF4-175	4	6 <sup>7</sup> / <sub>8</sub>	8 <sup>1</sup> / <sub>4</sub>	<sup>3</sup> / <sub>16</sub>	8
EF6-240	6	9 <sup>5</sup> / <sub>16</sub>	11	<sup>7</sup> / <sub>16</sub>	8

Dimensions-mm

Model	d	A	B	C	D	E	F	G	I	J	J1	K	L	M	N	O	O1	P	P1	W1	W2	H1	H2	H3	H4	WT1	Weight:kg	
																											GRS Set	WT2
100(150)AFE45.5	100	907	605	192	374	290	245	100	70	180	220	2"	60	380	315	176	280	24	40	739	328	838	52	250	16	110	T100B	45
100(150)AFE47.5	100	907	605	192	374	290	245	100	70	180	220	2"	60	380	315	176	280	24	40	779	328	878	52	250	16	120	T100B	45
100(150)AFE45.5	100	967	605	192	374	290	245	100	70	180	220	2"	60	410	315	176	280	24	40	739	328	838	52	250	16	110	T150(100)B	50
100(150)AFE47.5	100	967	605	192	374	290	245	100	70	180	220	2"	60	410	315	176	280	24	40	779	328	878	52	250	16	120	T150(100)B	50

Dimensions-inch

Model	d	A	B	C	D	E	F	G	I	J	J1	K	L	M	N	O	O1	P	P1	W1	W2	H1	H2	H3	H4	WT1	Weight:lb	
																											GRS Set	WT2
100(150)AFE45.5	4	35 <sup>7</sup> / <sub>16</sub>	23 <sup>3</sup> / <sub>16</sub>	7 <sup>5</sup> / <sub>16</sub>	14 <sup>3</sup> / <sub>4</sub>	11 <sup>1</sup> / <sub>16</sub>	9 <sup>5</sup> / <sub>16</sub>	3 <sup>15</sup> / <sub>16</sub>	2 <sup>3</sup> / <sub>4</sub>	7 <sup>1</sup> / <sub>16</sub>	8 <sup>11</sup> / <sub>16</sub>	2	2 <sup>3</sup> / <sub>8</sub>	14 <sup>15</sup> / <sub>16</sub>	12 <sup>3</sup> / <sub>8</sub>	6 <sup>15</sup> / <sub>16</sub>	11	1 <sup>5</sup> / <sub>16</sub>	1 <sup>1</sup> / <sub>16</sub>	29 <sup>9</sup> / <sub>16</sub>	12 <sup>15</sup> / <sub>16</sub>	33	2 <sup>1</sup> / <sub>16</sub>	9 <sup>13</sup> / <sub>16</sub>	5 <sup>5</sup> / <sub>16</sub>	243	T100B	99
100(150)AFE47.5	4	35 <sup>7</sup> / <sub>16</sub>	23 <sup>3</sup> / <sub>16</sub>	7 <sup>5</sup> / <sub>16</sub>	14 <sup>3</sup> / <sub>4</sub>	11 <sup>1</sup> / <sub>16</sub>	9 <sup>5</sup> / <sub>16</sub>	3 <sup>15</sup> / <sub>16</sub>	2 <sup>3</sup> / <sub>4</sub>	7 <sup>1</sup> / <sub>16</sub>	8 <sup>11</sup> / <sub>16</sub>	2	2 <sup>3</sup> / <sub>8</sub>	14 <sup>15</sup> / <sub>16</sub>	12 <sup>3</sup> / <sub>8</sub>	6 <sup>15</sup> / <sub>16</sub>	11	1 <sup>5</sup> / <sub>16</sub>	1 <sup>1</sup> / <sub>16</sub>	30 <sup>3</sup> / <sub>16</sub>	12 <sup>15</sup> / <sub>16</sub>	34 <sup>1</sup> / <sub>16</sub>	2 <sup>1</sup> / <sub>16</sub>	9 <sup>13</sup> / <sub>16</sub>	5 <sup>5</sup> / <sub>16</sub>	265	T100B	99
100(150)AFE45.5	4	38 <sup>1</sup> / <sub>16</sub>	23 <sup>3</sup> / <sub>16</sub>	7 <sup>5</sup> / <sub>16</sub>	14 <sup>3</sup> / <sub>4</sub>	11 <sup>1</sup> / <sub>16</sub>	9 <sup>5</sup> / <sub>16</sub>	3 <sup>15</sup> / <sub>16</sub>	2 <sup>3</sup> / <sub>4</sub>	7 <sup>1</sup> / <sub>16</sub>	8 <sup>11</sup> / <sub>16</sub>	2	2 <sup>3</sup> / <sub>8</sub>	16 <sup>1</sup> / <sub>8</sub>	12 <sup>3</sup> / <sub>8</sub>	6 <sup>15</sup> / <sub>16</sub>	11	1 <sup>5</sup> / <sub>16</sub>	1 <sup>1</sup> / <sub>16</sub>	29 <sup>9</sup> / <sub>16</sub>	12 <sup>15</sup> / <sub>16</sub>	33	2 <sup>1</sup> / <sub>16</sub>	9 <sup>13</sup> / <sub>16</sub>	5 <sup>5</sup> / <sub>16</sub>	243	T150(100)B	110
100(150)AFE47.5	4	36 <sup>1</sup> / <sub>16</sub>	22 <sup>1</sup> / <sub>16</sub>	7 <sup>5</sup> / <sub>16</sub>	13 <sup>3</sup> / <sub>16</sub>	11 <sup>1</sup> / <sub>16</sub>	9 <sup>5</sup> / <sub>16</sub>	3 <sup>15</sup> / <sub>16</sub>	2 <sup>3</sup> / <sub>4</sub>	7 <sup>1</sup> / <sub>16</sub>	8 <sup>11</sup> / <sub>16</sub>	2	2 <sup>1</sup> / <sub>8</sub>	16 <sup>1</sup> / <sub>8</sub>	12 <sup>3</sup> / <sub>8</sub>	6 <sup>15</sup> / <sub>16</sub>	11	1 <sup>5</sup> / <sub>16</sub>	1 <sup>1</sup> / <sub>16</sub>	30 <sup>7</sup> / <sub>16</sub>	13 <sup>3</sup> / <sub>8</sub>	34 <sup>3</sup> / <sub>4</sub>	2 <sup>1</sup> / <sub>16</sub>	9 <sup>13</sup> / <sub>16</sub>	5 <sup>5</sup> / <sub>16</sub>	249	T150(100)B	110

C.W.L.:Continuous Running Water Level  
L.W.L.:Lowest Running Water Level

WT1:Pump Weight(Without Cable)  
WT2:GRS Set Weight

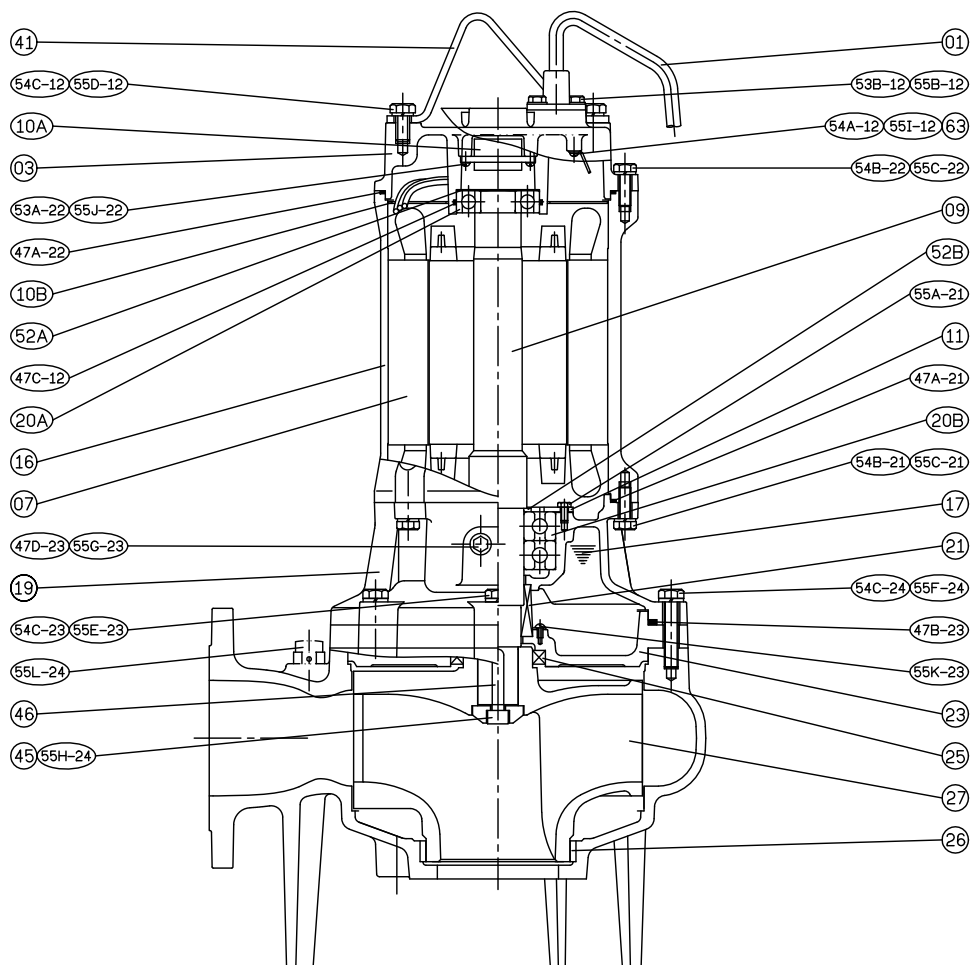

No.	Part name	Material	QTY	Remark
01	Cable		1	
03	Upper cover	FC200	1	
07	Stator		1	
09	Shaft end	SUS420J2	1	
10A	Auto-cut Protector		1	
10B	Protective Plate		1	
11	Bearing fixer	SPCC	1	
16	Motor frame	FC200	1	
17	Lubricant			
19	Bearing bracket	FC200	1	
20A	Bearing		1	
20B	Bearing		2	
21	M.seal	CA / CE & SIC / SIC	1	

No.	Part name	Material	QTY	Remark
23	M. seal bracket	FC200	1	
25	Oil seal	NBR	1	
26	Casing	FC200	1	
	+Wear ring	BC6	1	
27	Impeller	FC200	1	
41	Handle	SUS304	1	
46	Impeller key	SUS304	1	
47	Packing			